

# FALCO

## FSZ100

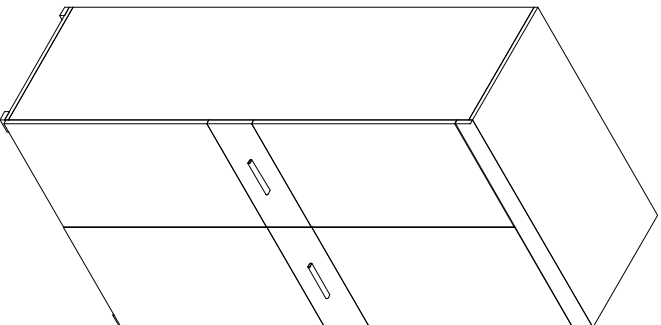

8.6.2017

- (D)** Montageanleitung
- (FR)** Notice de montage
- (NL)** Handleiding voor de montage
- (CZ)** Montážní návod
- (HU)** Szerelési útmutató
- (TR)** Montaj talimatı
- (GB)** Assembly Instructions
- (IT)** Istruzioni di montaggio
- (PL)** Instrukcja montażu
- (SK)** Návod na montáž
- (RO)** Instrucțiunile de montaj
- (RU)** Инструкции по монтажу

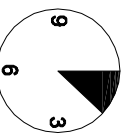
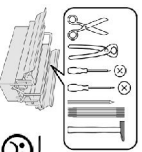

20 min.

1

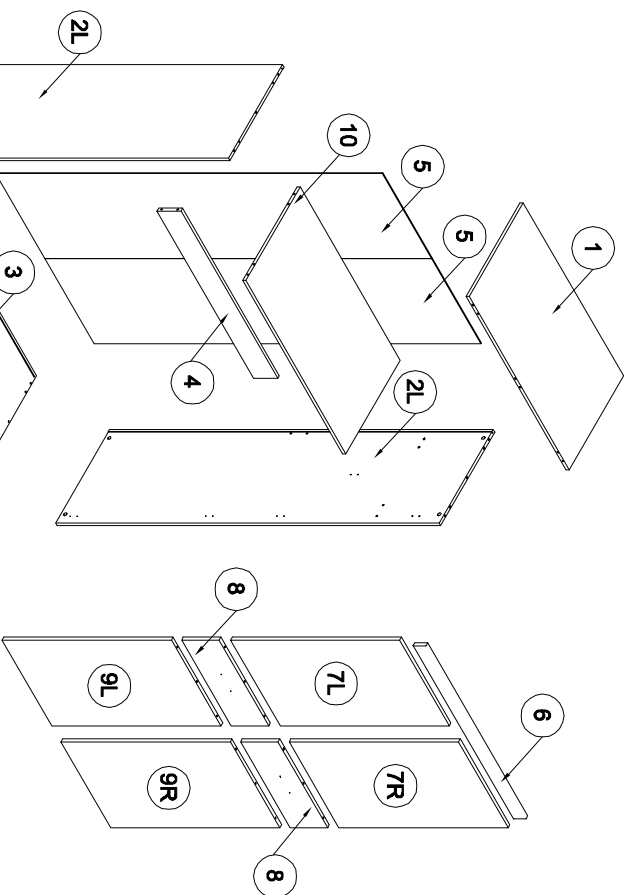

<b>P</b> X8 	<b>NA</b> 4x13 X16 	<b>YA</b> 4x27 X4 	<b>W</b> X2 	<b>AB</b> 6x39 X16 	<b>Y</b> X4 	<b>S</b> L-1918mm X1 	<b>GLUE</b> X1 	<b>X</b> X12 
<b>B</b> X15 	<b>ND</b> 3.5x16 X10 	<b>T</b> X2 	<b>H</b> 6.5x13 X16 	<b>A</b> 6x32 X19 	<b>R</b> X8 	<b>N</b> 3x20 X6 	<b>W6</b> L-960mm X1 	<b>C</b> X15 
<b>NOI</b> 	<b>OKI</b> 							<b>Z</b> X15 

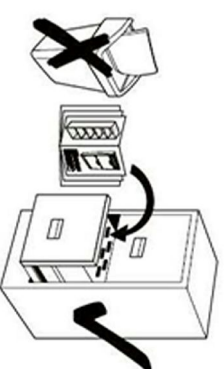
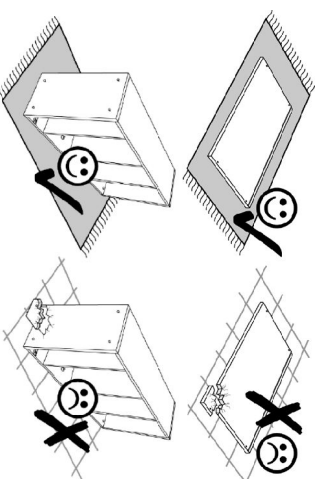

2

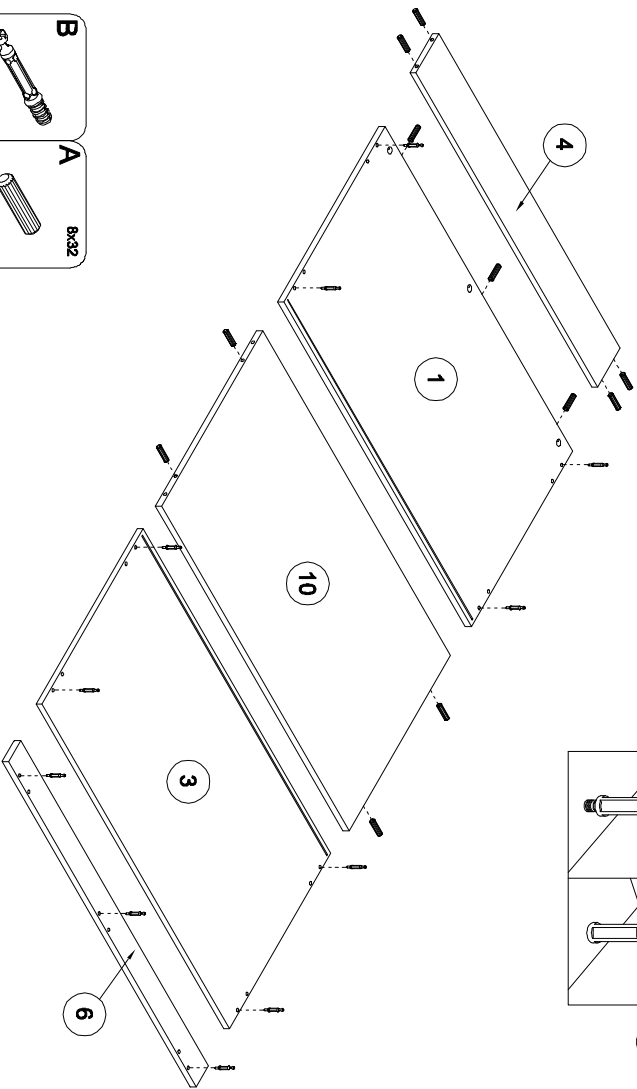
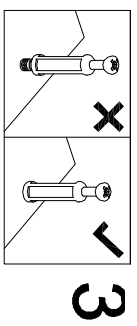

- B** x11
- A** 8x32 x11

- 1** x11
- 2** x11

**4**

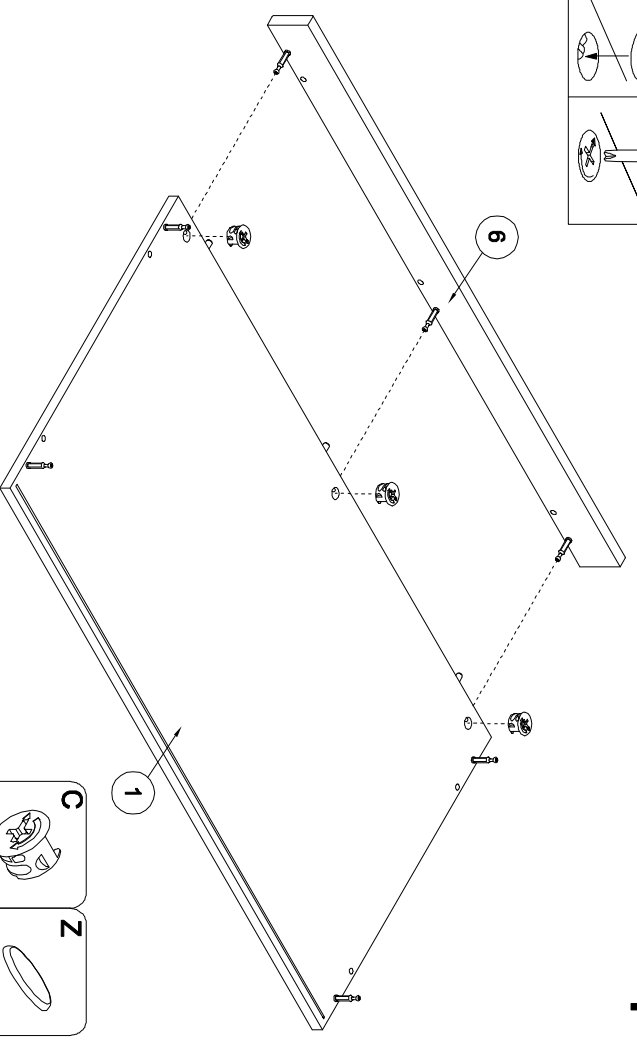

- C** x3
- Z** x3

**5**

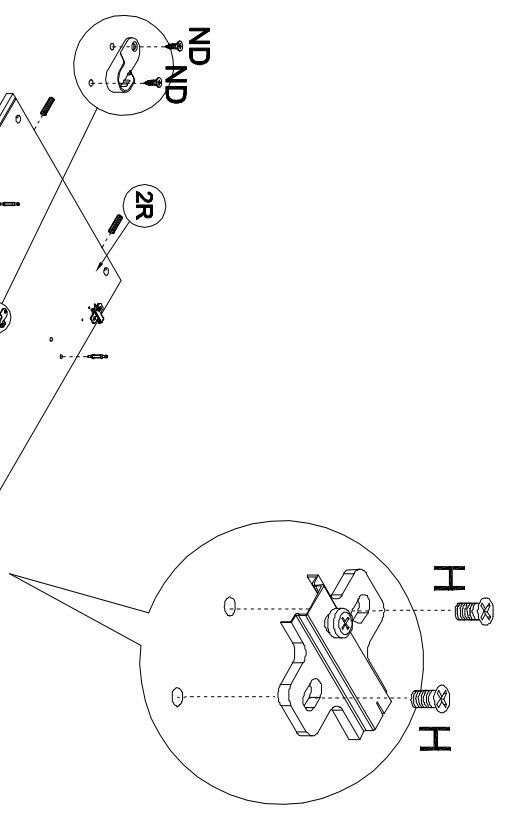

- ND** 3.5x16 x4
- T** x2 8x32
- B** x4 6.5x13
- A** x8 8x32
- H** x4
- R** x16

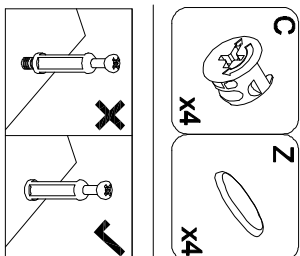
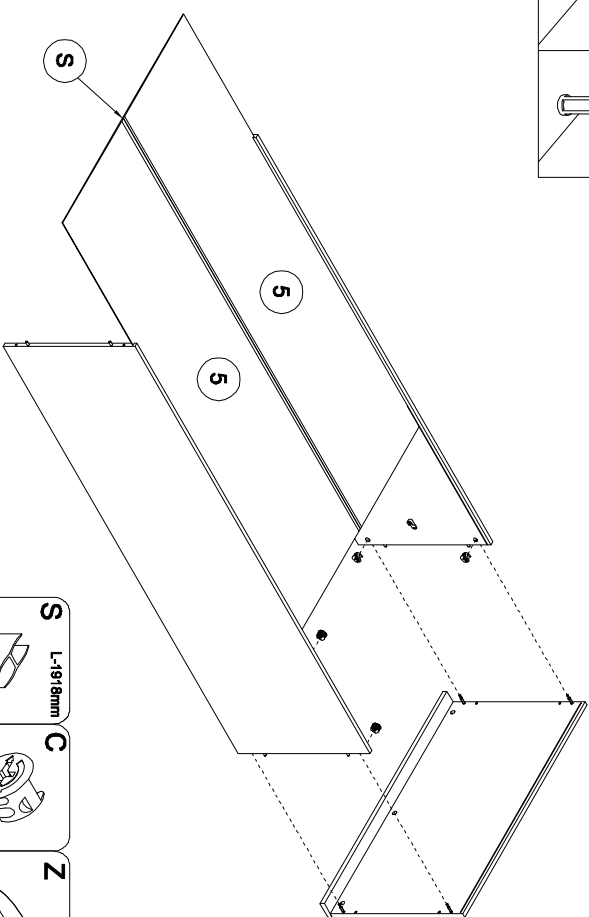
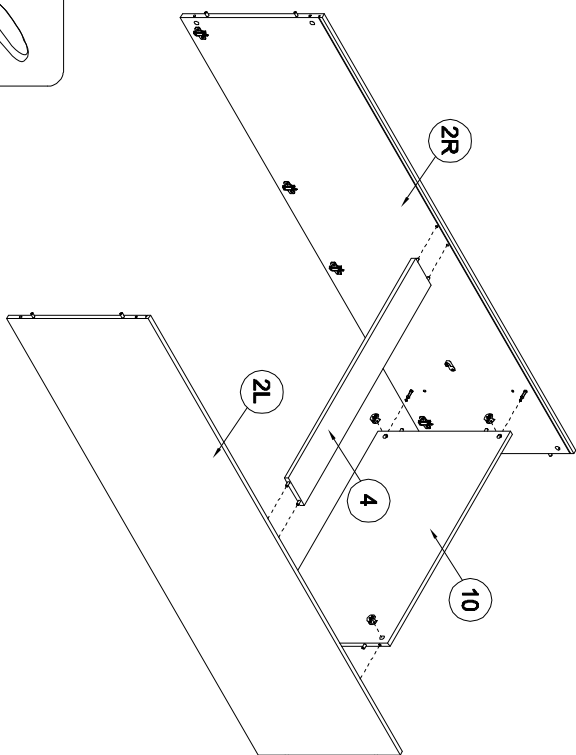
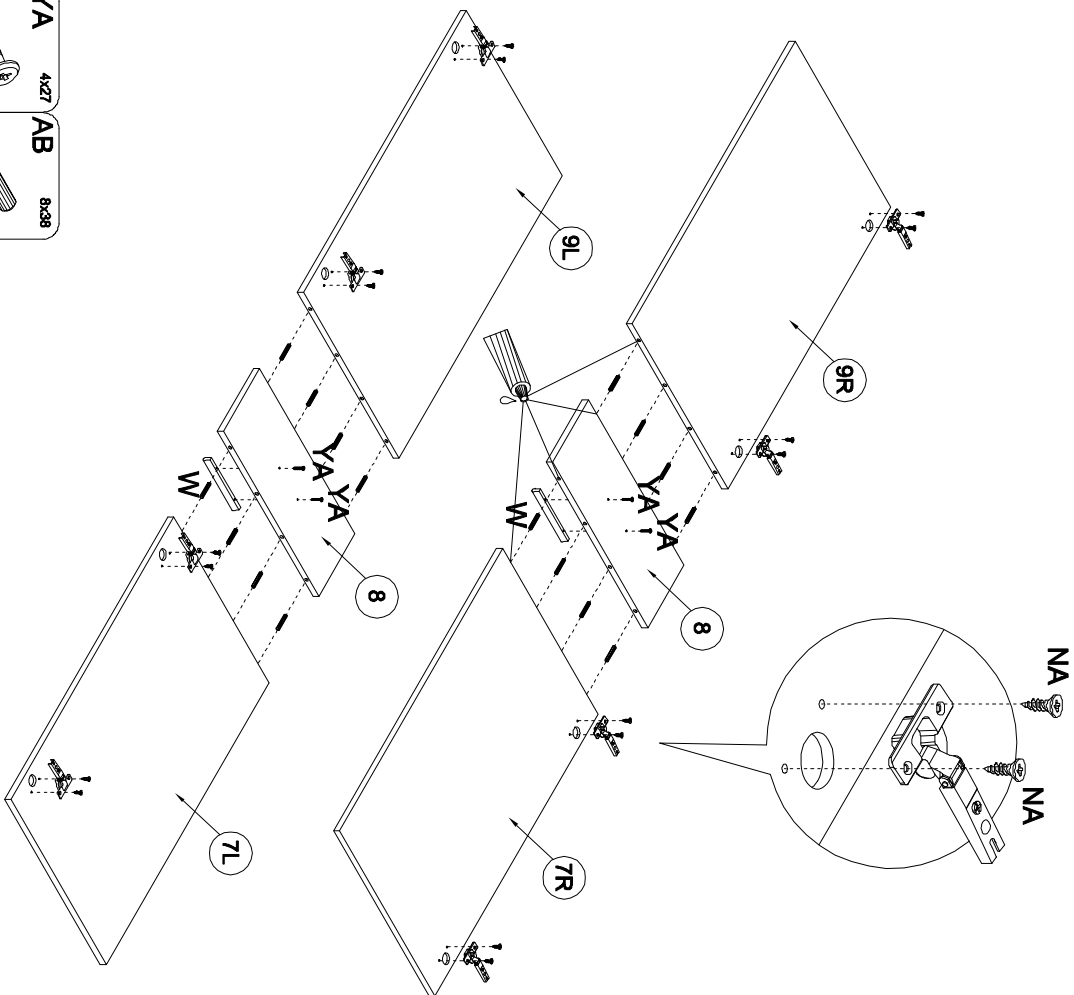

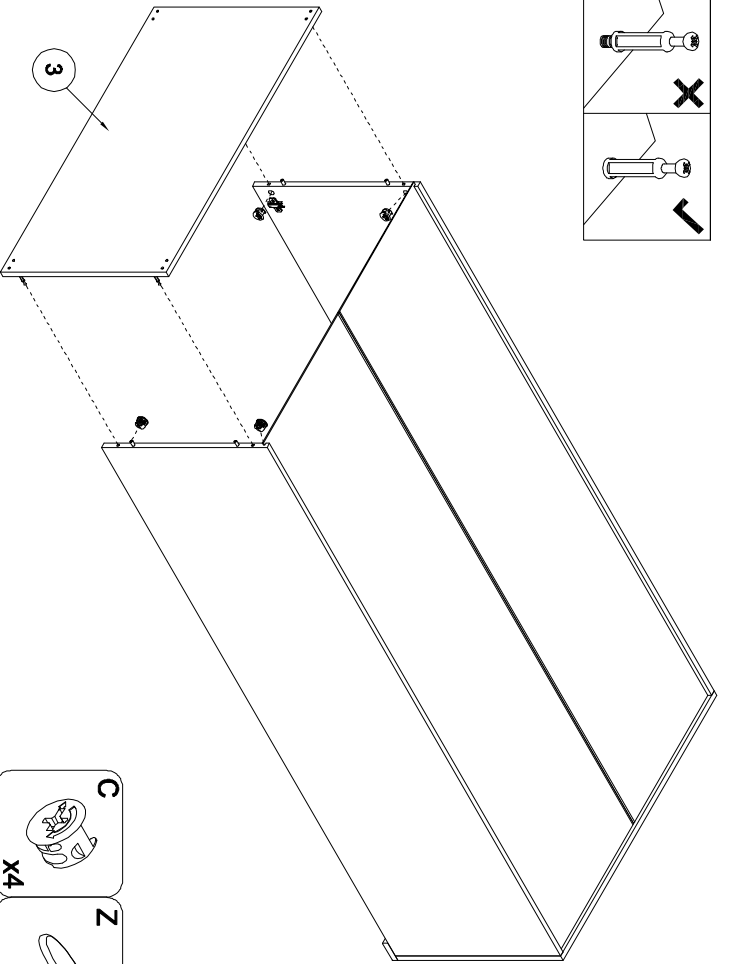
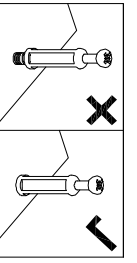

9

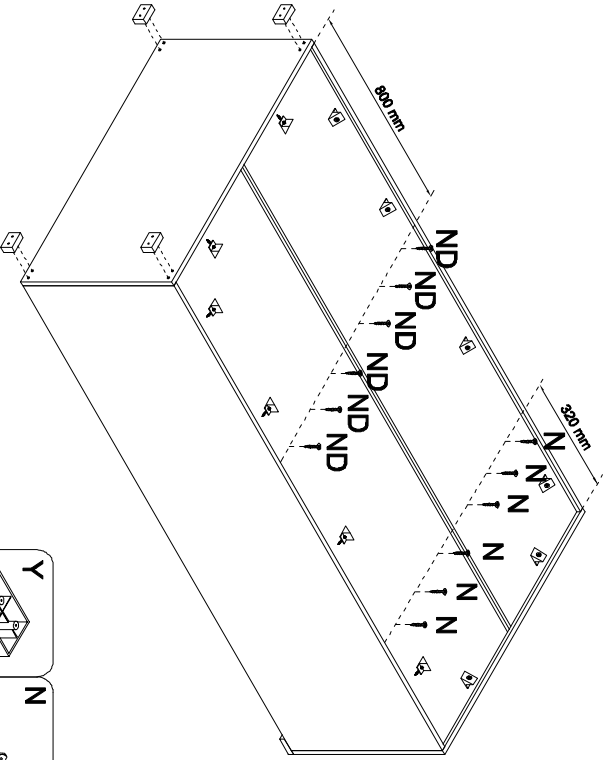
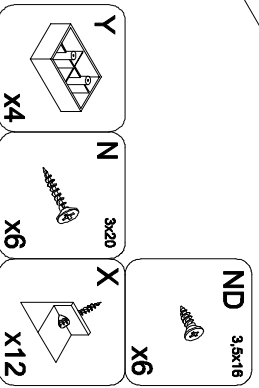
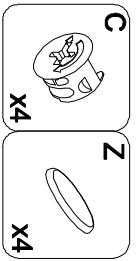

10

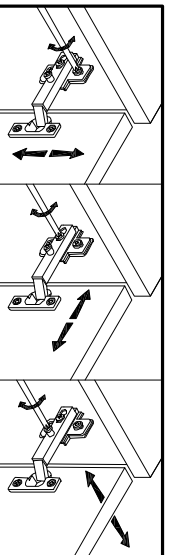

11

